

LEGEND

- EXISTING
- PROPOSED



**DESIGN
EXTENSION**

125, 420 London road,
Croydon, CR0 2NT
Tel: 020 7856 0495
E: planning@designextension.co.uk
www.designextension.co.uk

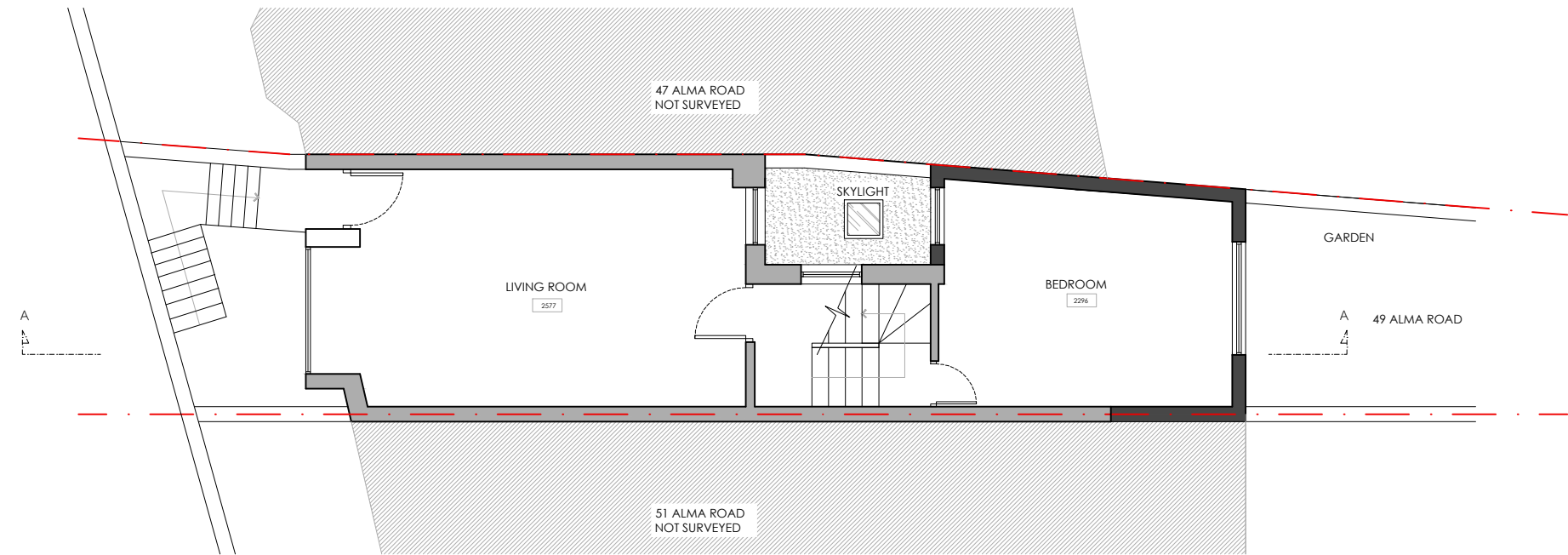

PROPOSED GROUND FLOOR PLAN

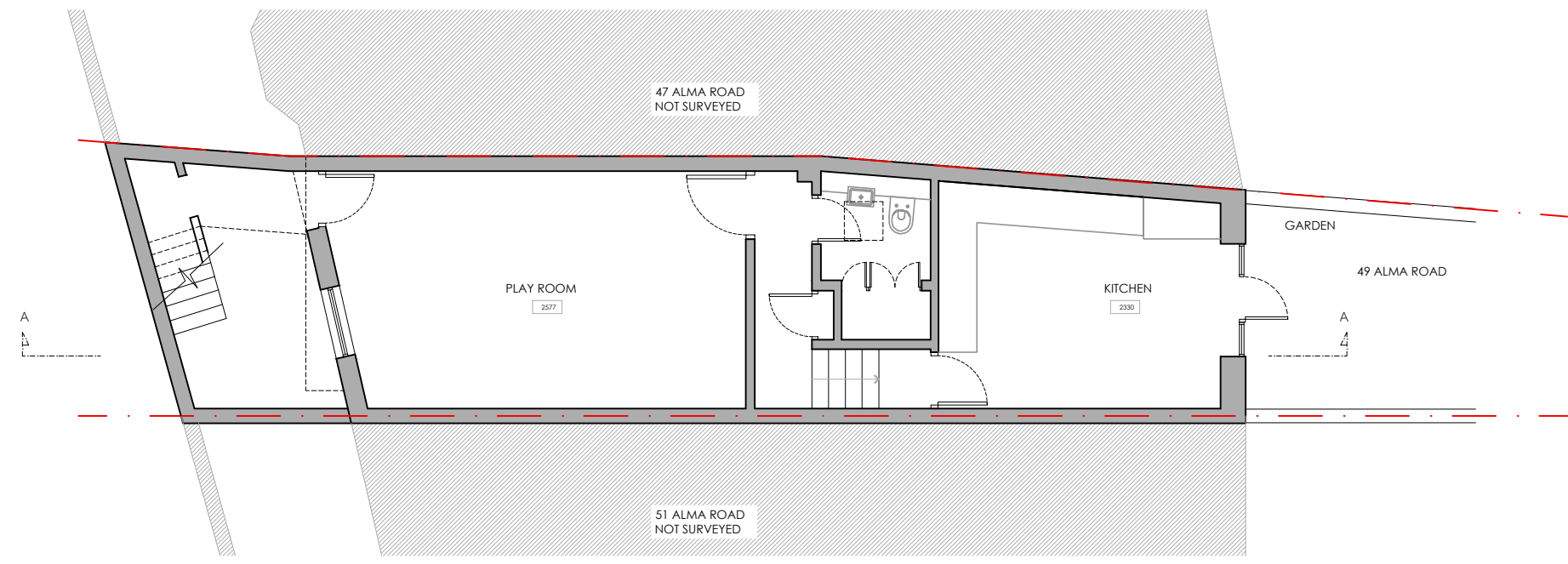

PROPOSED LOWER GROUND FLOOR PLAN (NO CHANGES)



Planning Application

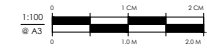

Drawn
Ian and Kate Stanbury

Site
**49 Alma Road
SW18 1AE**

Use
Rear Extension

Proposed
Floor Plans

Drawn
P101
Scale
1:100
Date
Jan/17

Notes
This drawing is copyright © 2014.
1. The drawings shall be used
2. The proposed is to be carried out
3. The proposed is subject to all statutory approvals
4. The proposed must not be used for any other purpose
other than stated above.